

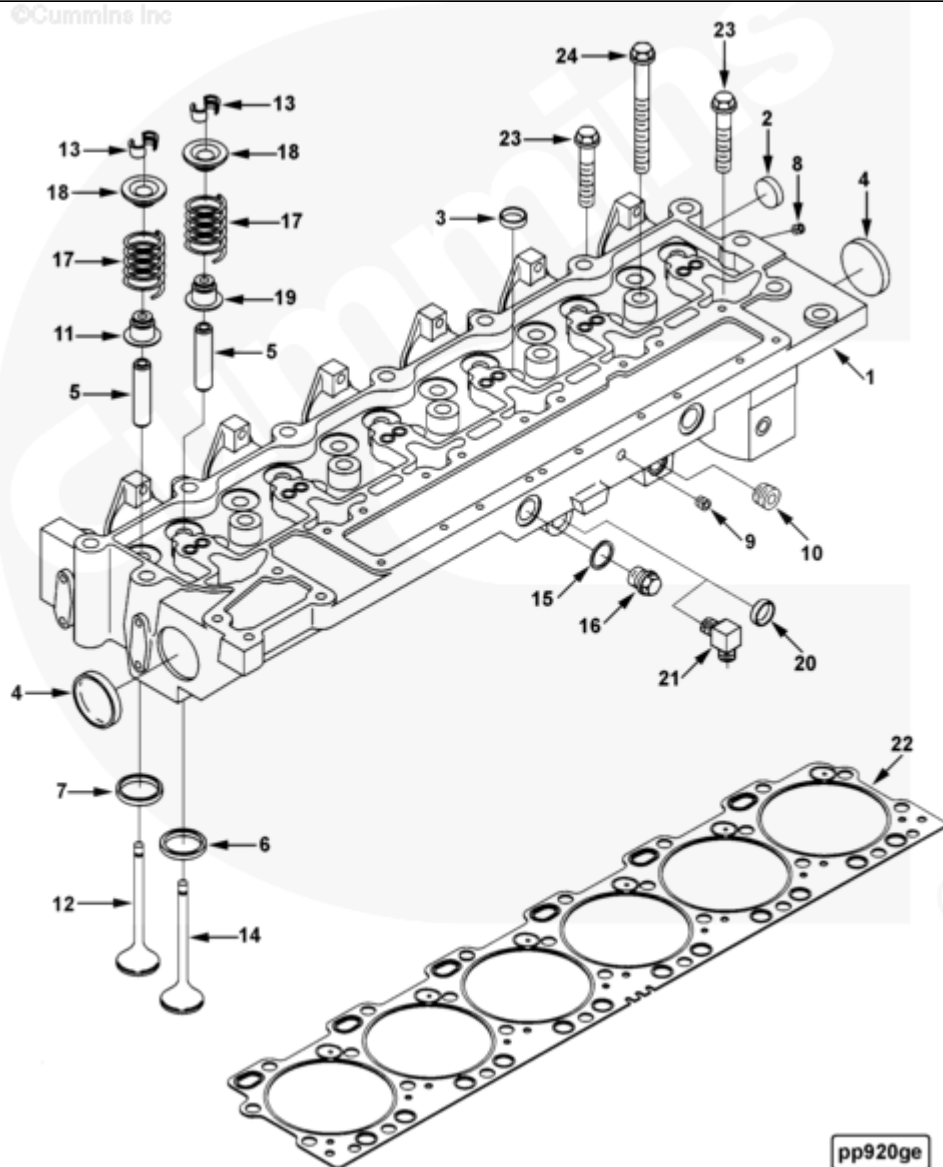

## Parts Catalog - Option Detail

Electronic Parts Catalog - Option Detail				
Option	Group	Graphic	Film Card	Date
PP9830	02.01	pp920ge	Z	12-DEC-95
Engines	6C8.3, C GAS PLUS CM556, G8.3, G8.3 CM558, GTA8.3 CM558, ISC CM2150, ISC CM554, ISC CM850, ISC8.3 CM2250, ISC8.3 G CM2180 C101, ISL CM2150, ISL CM554, ISL CM850, ISL G CM2180, ISL8.9 CM2150 L110, ISL8.9 CM2880 L112, ISL9 CM2150 SN, ISL9 CM2250, ISL9 CM2350 L101, ISL9 CM2350 L111, ISLE4 CM850, L GAS PLUS CM556, L8.9, L8.9 L121, L8.9G CMOH2.0 L125B, L9 CM2350 L116B, L9 CM2350 L119B, L9 CM2350 L120C, L9 CM2350 L123B, L9.3 L105, L9.5 L117, L9N CM2380 L124B, QSC8.3 CM2250, QSC8.3 CM2880 C102, QSC8.3 CM554, QSC8.3 CM850(CM2850), QSL9 CM2250, QSL9 CM2250 L115, QSL9 CM2350 L102, QSL9 CM2350 L107, QSL9 CM2350 L118, QSL9 CM2350 L122, QSL9 CM554, QSL9 CM850(CM2850), QSL9 G CM558, QSL9 M CM2250 L106, QSL9.3 CM2880 L113			



pp920ge

SMALL | MEDIUM | LARGE

Cart	Ref No	Part Number	Part Description	Required	Remarks
View My Cart					
		PP9830	Cylinder Head		MR - HEAD, CYLINDER...(More)
					Engine Family: C Series
					Engine Design Phase: Current
					Product
					Cylinder: 6
					Swirl: Low
					MFLD Pressure to Lift EXH
					Valve (PSI): 30
					Air Compressor Inlet
					Coupling: Without
					Notched Head: No
					Cylinder Head Material: Cast
					Iron
					Cylinder Head Valve Material:
					Premium
					Exhaust Manifold Type: Dry
					Valve Seat Inserts: No
					Valve Bridge Scalloping: No
					Compression Brake Mounting
					Hardware: No
					Aspiration:
					- Charge Air Cooled;
					- Jacket Water Aftercooled;
					- Naturally Aspirated;
					- Turbocharged
					NOTE: When Air Compressor is
					Used, Elbow Hose Coupling
					3924138 Needs to be Used in

					Place of 3912900 Expansion
					Plug
<input type="checkbox"/>		3802465	Cylinder Head	1	Recon Equivalent 3802465 RX
<input type="checkbox"/>	1	3925642	Cylinder Head	1	
<input type="checkbox"/>	2	3920443	Expansion Plug	1	
<input type="checkbox"/>	3	3032693	Expansion Plug	5	1.198 in.
<input type="checkbox"/>	4	3922072	Expansion Plug	2	
<input type="checkbox"/>	5	3923564	Valve Stem Guide	12	
<input type="checkbox"/>	6	3928174	Valve Insert	6	Exhaust
<input type="checkbox"/>	7	3924582	Valve Insert	6	Intake
<input type="checkbox"/>	8	3008464	Pipe Plug	1	1/16 NPT
<input type="checkbox"/>	9	3008466	Pipe Plug	1	1/4 NPT.
<input type="checkbox"/>	10	3008468	Pipe Plug	1	1/2 NPT.
<input type="checkbox"/>	11	3915707	Valve Stem Seal	6	
<input type="checkbox"/>		3802463	Intake Valve Kit		
	12	3924492	Intake Valve	6	Sold In Higher Level Assy/Kit
<input type="checkbox"/>	13	3901177	Valve Collet	12	
<input type="checkbox"/>		3802085	Exhaust Valve	6	
	14	3921444	Exhaust Valve	6	Sold In Higher Level Assy/Kit
<input type="checkbox"/>	13	3901177	Valve Collet	12	
<input type="checkbox"/>	15	3902425	Sealing Washer	2	M22
<input type="checkbox"/>	16	3924148	Threaded Plug	2	M22 x 1.50 x 14
<input type="checkbox"/>	17	3906412	Valve Spring	12	Standard
	18	3912976	Valve Spring Retainer	12	
<input type="checkbox"/>	19	3919038	Valve Stem Seal	6	
<input type="checkbox"/>	20	3912900	Expansion Plug	1	
<input type="checkbox"/>	21	3924138	Elbow Hose Coupling	1	Replaces 3912900 Plug When
					Air Compressor is Used
<input type="checkbox"/>	22	3928168	Cylinder Head Gasket	1	

<input type="checkbox"/>	23	<a href="#">3917729</a>	Fracture Resistant Screw	12	M14 X 2.00 X 80.
<input type="checkbox"/>	24	<a href="#">3917728</a>	Hexagon Flange Head Cap Screw	14	M14 x 2.00 x 160
<input type="checkbox"/>		<a href="#">3928180</a>	Cylinder Head Gasket	1	
<input type="checkbox"/>		<a href="#">3928181</a>	Cylinder Head Gasket	1	

© 2019 Cummins Inc., Box 3005, Columbus, IN 47202-3005 U.S.A.  
 Terms of Use and Disclaimers | Recommended System Requirements  
 Need Assistance? Please click on the Contact Us button in the top right corner of any page.